

Smart LV Switch-SS001

SMART SOLUTIONS FOR SMART HOMES

.....

QUICK GUIDE



Electronics Design &
Manufacturing PTY LTD



Description

The SS001 Low voltage WiFi Switch is an Interactive Home product that can be controlled via Interactive Home APP, Google Assistant, Amazon Alexa, IFTTT and Siri. This product allows you to control Garage Door's, Automatic Gates, Alarm Systems and any other product that can be triggered using a dry contact.

The unit can be powered from an AC or DC power source ranging from 9-27V. Making it extremely versatile.

Status Light

- Rapid Flashing Blue Light: Awaiting WiFi Connect
- Slow Flashing Blue Light: AP Mode
- Solid Blue Light: Connected, Switch OFF
- Solid Red Light: Connected, Switch ON

Reset

Press and hold reset button for 5 seconds until you hear click and blue light starts flashing rapidly.

Connect

Download

Interactive Home is available for both IOS and Android. Search "Interactive Home" on the Apple / Google Play Store, or scan the QR-Code below.



Set up router

This device only supports 2.4GHz WiFi frequency, it does not support 5GHz frequency or special characters such as !@#\$%^&*(). Please set the relevant parameters of the router before WiFi configuration. When your router is configured successfully, ensure your phone and device are within strong WiFi range.

Installation

- Select a suitable location indoors within WiFi range.
- Connect a suitable power source 9-27V AC/DC typically from the device you intend to operate.

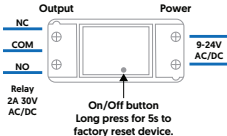

Low voltage WiFi Switch

9-27V DC/AC



Garage Door Controller



24V

Common

OSC
[Open, Stop,
Close]

- Refer to manual of device you intend to operate and connect trigger wires to the appropriate relay contacts.
- To check correct wiring, press on/off button.

Setup

Easy Mode (**Recommended**): (Blue Light flashing Rapidly)

- Connect your mobile to the WiFi you want your device to be connected to.
- Click the “+” or “Add Device” and select “Smart Switch”.
- Follow the on screen instructions.
- Enter WiFi password.
- Await device connection and configuration.

AP Mode: (Blue Light Flashing Slowly)

- Click the “+” or “Add Device” and select “Smart Switch”.
- Select “AP Mode” in the top right corner.
- Click “Connect Now”, chose WiFi hotspot named “SmartLife-XXXX” then back to Interactive Home APP.
- Await device connection and configuration .

One Shot Mode

Many devices need a momentary trigger to activate. This section describes how to setup the relay in one shot mode.

This example is typical for a Garage Door.

Step 1

Make sure the SS001 is registered and you can control it using the Interactive Home APP.

Step 2

Select "Smart" at the bottom of the Interactive Home APP then select "Add Smart" or "+"

Step 3

Select "Automation", Set Automation name E.g. "Garage Door Auto Off"

Press + to add a new condition under "When one of the following conditions is met"
Select "Device -> Garage Door -> Switch -> ON"

Step 4

Press + to add a new execute action under "Add an execution action" select "Garage Door -> Countdown -> 2s"

Then press "Save"

Step 5

To test, trigger the Garage Door using APP or On/Off button on the unit. The relay should turn off after 2 seconds.

WARNING

When remotely operating automatic devices such as Garage Door's & Auto Gates, be sure there are no obstacles in the line of travel.

If unattended operation is required, we recommend the use of photo beams.

3RD Party Integration

With 3RD Party Integration you're able to connect your Interactive Home smart device to platforms/assistants that provide voice control, extra automation and more.



Works with
amazon alexa



Works with
Google Assistant



Works with
Siri Assistant



Works with
IFTTT

Learn more about 3RD party integration here

[Support.Interactivehome.com.au](https://support.interactivehome.com.au)

Contact Us

5/8 Millennium Court
Silverwater, Sydney
NSW, Australia, 2128
Admin@edm.com.au

Environment

Indoor Use Only
Humidity: 0% to 93% (non-condensing)
Temp: -10°C to +49°C

Support

Email: Support@edm.com.au
Phone: +61-2 9672 1777
Site: support.interactivehome.com.au

Approvals



AS/NZS 4268:2017,
CISPR 32:2015,

CE-RED



**Electronics Design &
Manufacturing PTY LTD**
ACN: 626 667 981