



Wired Bridge (BZ100-P)

Quick Start Guide

Compatible with Schlage Omnia
Smart Locks



Schlage Wired Bridge (BZ100-P)

Model :	Schlage Wired Bridge (BZ100-P)
Dimensions :	70mm x 70mm x 26mm
Network interface :	RJ45
Network rate :	10M/100M
IEEE standard :	802.3 / 802.3af (PoE)
Power interface :	Type-C USB/PoE
Power input :	5V/500mA powered by PoE

Light Status



When the Wired Bridge is powered on:

- Flashing Red/Blue light:
Stand-by mode - Ready to Pair
- Blue light: Normal mode
- Red light: Network failure

Warranty

The Schlage Wired Bridge (BZ100-P) has a one year warranty.

Our goods come with guarantees that cannot be excluded under the local consumer law. You are entitled to a replacement or refund for a major failure and for compensation for any other reasonably foreseeable loss or damage. You are also entitled to have the goods repaired or replaced if the goods fail to be of acceptable quality and the failure does not amount to a major failure.

Disclaimer

We continuously optimise products as new technologies and features are developed. For this reason, we reserve the right to make alterations to the products without prior notice.



ALLEGION

www.allegion.com.au
www.allegion.co.nz

Pair Wired Bridge with Schlage Breeze App

- 1 Activate the app



- 2 Touch the "☰" icon on the top left of the screen

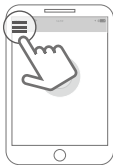

- 3 Select [Bridge]



- 4 Press "+" sign



- 5 Select [Wired]

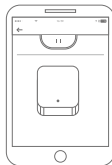

- 6 Connect the Bridge to the network and power it on. Wait until the light flashes alternately red and blue, then press next.

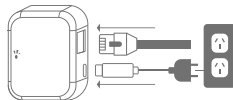

- 7 Add Wired Bridge
- 8 Name the Wired Bridge and select OK



Note: If the device times out, please power off to reset and try again.