

WL T62

Wireless Shock & Contact Detector



Installation Instructions



UK Tel: +44-(0)-161-655-5500
E-mail: support-uk@riscogroup.com

ITALY Tel: +39-02-66590054
E-mail: support-it@riscogroup.com

SPAIN Tel: +34-91-490-2133
E-mail: support-es@riscogroup.com

FRANCE Tel: +33-164-73-28-50
E-mail: support-be@riscogroup.com

BELGIUM Tel: +32-2522-7622
E-mail: support-be@riscogroup.com

U.S.A Tel: +1-631-719-4400
E-mail: support-usa@riscogroup.com

BRAZIL Tel: +55-11-3961-8767
E-mail: support-br@riscogroup.com

CHINA (Shanghai)
Tel: +86-21-52-93-0956
E-mail: support-cn@riscogroup.com

CHINA (Shenzhen)
Tel: +86-755-82789285
E-mail: support-cn@riscogroup.com

POLAND Tel: +48-22-500-28-40
E-mail: support-pl@riscogroup.com

ISRAEL Tel: +972-3-963-7777
E-mail: support@riscogroup.com

RISCO Group Limited Warranty

RISCO Group and its subsidiaries and affiliates ("Seller") warrants its products to be free from defects in materials and workmanship under normal use for 24 months from the date of production. Because Seller does not install or connect the product and because the product may be used in conjunction with products not manufactured by the Seller, Seller cannot guarantee the performance of the security system which uses this product. Seller's obligation and liability under this warranty is expressly limited to repairing and replacing, at Seller's option, within a reasonable time after the date of delivery, any product not meeting the specifications. Seller makes no other warranty, expressed or implied, and makes no warranty of merchantability or of fitness for any particular purpose. In no case shall seller be liable for any consequential or incidental damages for breach of this or any other warranty, expressed or implied, or upon any other basis of liability whatsoever. Seller's obligation under this warranty shall not include any transportation charges or costs of installation or any liability for direct, indirect, or consequential damages or delay. Seller does not represent that its product may not be compromised or circumvented; that the product will prevent any personal injury or property loss by burglary, robbery, fire or otherwise; or that the product will in all cases provide adequate warning or protection. Seller, in no event shall be liable for any direct or indirect damages or any other losses occurred due to any type of tampering, whether intentional or unintentional such as masking, painting or spraying on the lenses, mirrors or any other part of the detector. Buyer understands that a properly installed and maintained alarm may only reduce the risk of burglary, robbery or fire without warning, but is not insurance or a guaranty that such event will not occur or that there will be no personal injury or property loss as a result thereof. Consequently seller shall have no liability for any personal injury, property damage or loss based on a claim that the product fails to give warning. However, if seller is held liable, whether directly or indirectly, for any loss or damage arising under this limited warranty or otherwise, regardless of cause or origin, seller's maximum liability shall not exceed the purchase price of the product, which shall be complete and exclusive remedy against seller. No employee or representative of Seller is authorized to change this warranty in any way or grant any other warranty.

WARNING: This product should be tested at least once a week.

FCC NOTE (for 433MHz versions only):

This equipment has been tested and found to comply with the limits for a Class B digital device, pursuant to Part 15 of the FCC rules. These limits are designed to provide reasonable protection against harmful interference in a residential installation. This equipment generates, uses and can radiate radio frequency energy and, if not installed and used in accordance with the instructions, may cause harmful interference to radio communications. However, there is no guarantee that interference will not occur in a particular installation. If this equipment does cause harmful interference to radio or television reception, which can be determined by turning the equipment off and on, the user is encouraged to try to correct the interference by one or more of the following measures:

- Reorient or relocate the receiving antenna.
- Increase the separation between the equipment and receiver.
- Connect the equipment to an outlet on a circuit different from that to which the receiver is connected.
- Consult the dealer or an experienced radio/TV technician.

FCC Warning

The manufacturer is not responsible for any radio or TV interference caused by unauthorized modifications to this equipment. Such modifications could void the user's authority to operate the equipment.

FCC ID: JE4RW771X433

RTTE Compliance Statement

Hereby, RISCO Group declares that this equipment is in compliance with the essential requirements and other relevant provisions of Directive 1999/5/EC.

For the CE Declaration of Conformity please refer to our website: www.riscogroup.com.

© RISCO Group 04/11



5IN1323 C

Fig. 1

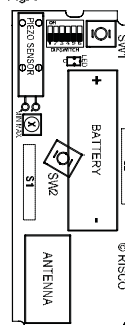

Fig. 2

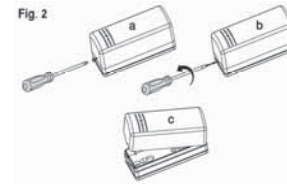

Fig. 3



Fig. 4



Fig. 5

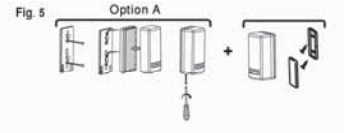

Option B

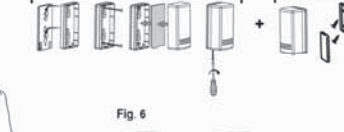

Fig. 6



ENGLISH

GENERAL DESCRIPTION

The WL T62 combines both a Shock detector and a Door/Window Contact detector in a single casing for internal use that provides reliable 24-hour perimeter protection. The detector employs an advanced digital microprocessor to analyze the vibration signal received from the piezo electric sensor. The WL T62 has a reed switch for protection against opening doors and windows, and against any attempt to tamper the detector using large magnets. This detector operates in conjunction with RISCO's programmable receiver and is powered by a standard 3-volt lithium battery.

MAIN FEATURES

- Digital Microprocessor with Intelligent Digital Signal Processing
- Tri-color LED enables accurate and reliable calibration, with "over-sensitive" and "under-sensitive" indications
- Gross attack detections
- Shock and Contact detection reported to separate zones in the receiver
- Detects attempts of magnet tampering (0.3T)
- Encapsulated bi-morph piezo electric sensor
- Dual stage adjustment potentiometer
- Back & Cover tamper protection
- Operates up to 300m (1000 ft) range (LOS)
- Uses one of more than 16 million addresses codes
- Hold on/off
- Fully supervised

DIPSWITCHES

Dipswitch	Description
1	Used to enable or disable LED
	Dipswitch Position LED
2	Used to determine the sensitivity of the Shock detector
	Dipswitch Position Sensitivity
3	Used to determine the detector HOLD status (Contact Only)
	Dipswitch Position Hold Status
4	Used to enable or disable the Contact
	Dipswitch Position Internal Reed Switch (S1)
5	Used to enable or disable the anti-sabotage function (Contact Only)
	Dipswitch Position Anti-Sabotage Reed Switch (S2)
6	Used to determine the detector RF power
	Dipswitch Position RF Power Transmission

LED INDICATION

After each detection, the LED turns ON momentarily. On Low Battery condition, the LED will blink during each transmission.

Color	Indication
GREEN	Indicates an alarm condition for Shock detection
RED	Indicates an alarm condition for Contact detection
ORANGE	Over-Sensitive indication for Shock detection

FRONT COVER REMOVAL

Remove the front cover as described in Figure 2.

TRANSMITTER/RECEIVER COMMUNICATION SET UP

The transmitter must identify itself to the system's receiver by writing its coded messages into the receiver's address memory. The receiver must identify the Shock detector and the Contact detector separately. This is accomplished by performing the following steps:

- Set the receiver to the Write Mode (follow the receiver's instructions).
 - Remove the battery from the insulation material and reinsert it into the transmitter, paying attention to the polarity (see Fig. 3).
 - Send a separate Write message to each detector. Use Dipswitch 3, as described in the table below, to choose a detector. To program the ID of a Shock detector set the Dipswitch to the OFF position and send a Write message by pressing both tamper buttons for at least 3 seconds.
- | Detector | Dipswitch 3 | Restore |
|------------------|---------------|---------|
| Shock detector | OFF (Default) | No |
| Contact Detector | ON | Yes |
- To program the ID of the Contact detector set Dipswitch 3 to ON and send a Write message by pressing both tamper buttons for at least 3 seconds.
 - Set the receiver to the Normal mode.
 - Verify that the receiver has identified each of the detectors by generating a tamper signal (by momentarily closing and opening both tampers). The tamper message will be sent twice, once for each detector.

NOTE: If for any reason it is necessary to re-send a write message, press both of the tamper buttons (back and cover) for at least 3 seconds.

INSTALLATION INSTRUCTIONS

Considerations for wireless communication

- For best wireless communication, place the unit at the highest possible position.
- Temporarily attach the unit to this point using two sided adhesive tape.
- Generate an Alarm or Tamper signal and verify that the receiver has received the signal. If the signal is not detected, reposition the transmitter and try again.

Considerations for shock detection

- Select the intended position for installation, ensuring the surface is clean and clear of any irregularities. Refer to Table 1 for details about detection ranges for the different surface types.
- Set the detector's sensitivity as follows, using the sensitivity trimmer:
 - With the unit set for normal operation, use a suitable instrument to bang or tap the protected area.
 - If the sensitivity needs adjustment, use a screwdriver to adjust the trimmer (turn the trimmer control clockwise to increase sensitivity or counter-clockwise to reduce sensitivity).
 - Repeat steps i and ii until the desired sensitivity level is achieved. If required, you can set Dipswitch 2 to OFF to reduce sensitivity range.
- Close the front cover.

Table 1: Typical Detection Range

Surface	Concrete	Brick Wall	Steel	Glass	Wood	Plywood
Radius	1.5m 5ft	2.5m 8.2ft	3m 10ft	3.5m 11.5ft	3.5m 11.5ft	4m 13ft

The above values are typical and are subject to practical testing, which must be performed for each installation. In some environments, these values may differ from the values listed above.

Considerations for magnet installation

- Install the WL T62 in a place that enables you to install the magnet in parallel to it (for example: door frame).

b. Install the magnet on the right side of the WL T62 as indicated in Figure 6.

NOTES:

- Maximum distance of the magnet from the detector is 20mm (0.7inch).
- Position the magnet as close as possible to the same plane level as the back surface of the WL T62.
- The mark on the magnet's plastic case should be opposite to the mark on the detector's case.
- Placing the magnet on the wrong side of the WL T62 will cause a tamper alarm signal.

FINAL MOUNTING

Separate the back part of the transmitter (Fig. 4), and mount all the parts in place (Fig. 5).

SPECIFICATIONS

ELECTRICAL	
Battery Type:	CR123 3V Lithium Battery
Current Consumption:	10µA standby
Frequency:	433.92 / 868.65 MHz
Supervision Transmission:	868.65 MHz model: every 15 minutes 433.92 MHz model: every 65 minutes
Modulation Type:	ASK
Battery Life:	3 years depends on usage
PHYSICAL	
Size:	81 x 35 x 32 mm (3.2 x 1.37 x 1.27 in.)
ENVIRONMENTAL	
RF immunity:	According to EN-50130-4
Operating temperature:	0°C to 55°C (32°F to 131°F)
Storage temperature:	-20°C to 60°C (-4°F to 140°F)
Maximum humidity:	95% non-condensing

Specifications are subject to change without prior notice. Should any questions arise please contact your supplier.

ORDERING INFORMATION

Model	Description
WL T62	WL Shock & Contact, 433/868 MHz, White/Brown