

# Wireless Twin Beam

Model: RWT74

## Assembly & Installation Instructions

Tx Rail Rx Rail

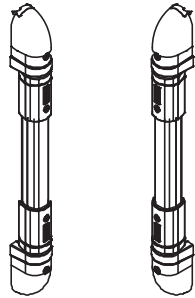

**RISCO**  
GROUP

Creating Security Solutions.  
*With Care.*  
riscogroup.com

© RISCO Group 03/2012

5IN1526 B

### RTTE Compliance Statement

Risco Ltd. hereby declares that this equipment is in compliance with the essential requirements and other relevant provisions of Directive 1999/5/EC. For the CE Declaration of Conformity please refer to our website: [www.riscogroup.com](http://www.riscogroup.com).

**CE** All rights reserved. No part of this document may be reproduced in any form without prior written permission from the publisher.

### RISCO Group Contacting Info

RISCO Group is committed to customer service and product support. You can contact us through our website ([www.riscogroup.com](http://www.riscogroup.com)) or at the following telephone and fax numbers:

**UK** Tel: +44-(0)-161-655-5500  
E-mail: [support-uk@riscogroup.com](mailto:support-uk@riscogroup.com)

**ITALY** Tel: +39-02-66590054  
E-mail: [support-it@riscogroup.com](mailto:support-it@riscogroup.com)

**SPAIN** Tel: +34-91-490-2133  
E-mail: [support-es@riscogroup.com](mailto:support-es@riscogroup.com)

**FRANCE** Tel: +33-164-73-28-50  
E-mail: [support-fr@riscogroup.com](mailto:support-fr@riscogroup.com)

**BELGIUM** Tel: +32-2522-7622  
E-mail: [support-be@riscogroup.com](mailto:support-be@riscogroup.com)

**U.S.A** Tel: +1-631-719-4400  
E-mail: [support-usa@riscogroup.com](mailto:support-usa@riscogroup.com)

**BRAZIL** Tel: +55-11-3661-8767  
E-mail: [support-br@riscogroup.com](mailto:support-br@riscogroup.com)

**CHINA (Shanghai)** Tel: +86-21-52-39-0066  
E-mail: [support-cn@riscogroup.com](mailto:support-cn@riscogroup.com)

**CHINA (Shenzhen)** Tel: +86-755-82789285  
E-mail: [support-cn@riscogroup.com](mailto:support-cn@riscogroup.com)

**POLAND** Tel: +48-22-500-28-40  
E-mail: [support-pl@riscogroup.com](mailto:support-pl@riscogroup.com)

**ISRAEL** Tel: +972-3-963-7777  
E-mail: [support@riscogroup.com](mailto:support@riscogroup.com)

### FCC Note:

Only the 433.92 MHz version is FCC approved and to be sold in US. The manufacturer is not responsible for any radio or TV interference caused by unauthorized modifications to this equipment. Such modifications could void the user's authority to operate the equipment

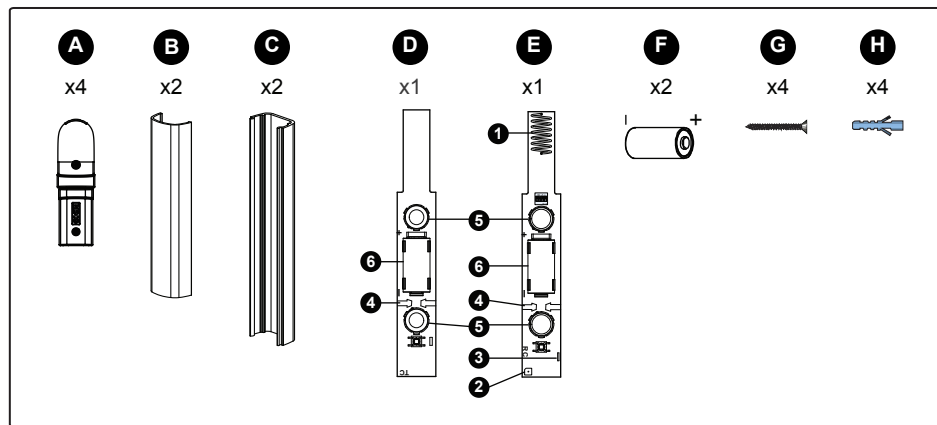

- A. Rail holder
- B. IR filter cover
- C. Aluminum rail
- D. Tx
- E. Rx
- F. Battery
- G. Screw
- H. Dibble
- 1. Antenna
- 2. Buzzer
- 3. Alarm LED
- 4. PCB Spring locker
- 5. IR Lens
- 6. Battery compartment

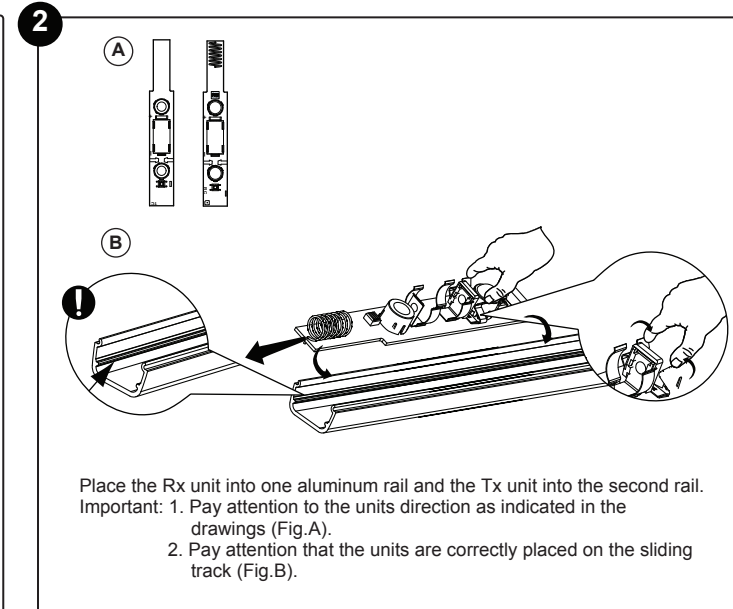
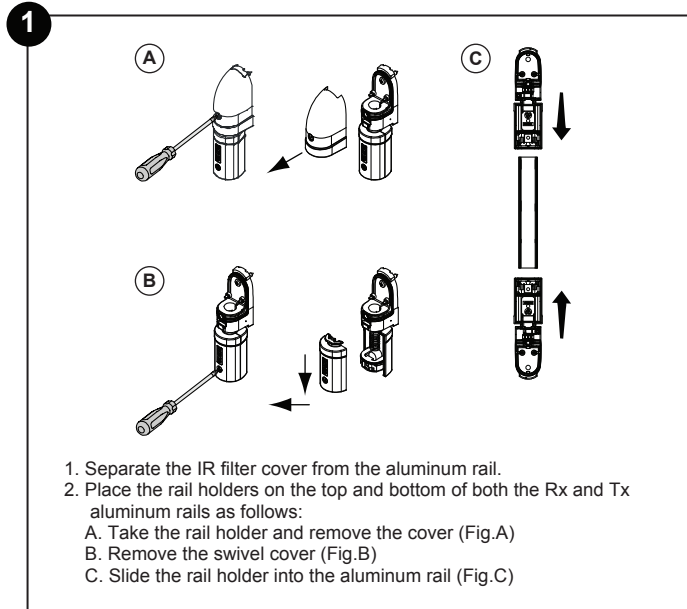

### RISCO Group Limited Warranty

RISCO Group and its subsidiaries and affiliates ("Seller") warrants its products to be free from defects in materials and workmanship under normal use for 24 months from the date of production. Because Seller does not install or connect the product and because the product may be used in conjunction with products not manufactured by the Seller, Seller cannot guarantee the performance of the security system which uses this product. Seller's obligation and liability under this warranty is expressly limited to repairing and replacing, at Seller's option, within a reasonable time after the date of delivery, any product not meeting the specifications. Seller makes no other warranty, expressed or implied, and makes no warranty of merchantability or of fitness for any particular purpose. In no case shall seller be liable for any consequential or incidental damages for breach of this or any other warranty, expressed or implied, or upon any other basis of liability whatsoever. Seller's obligation under this warranty shall not include any transportation charges or costs of installation or any liability for direct, indirect, or consequential damages or delay. Seller does not represent that its product may not be compromised or circumvented; that the product will prevent any personal injury or property loss by burglary, robbery, fire or otherwise; or that the product will in all cases provide adequate warning or protection. Buyer understands that a properly installed and maintained alarm may only reduce the risk of burglary, robbery or fire without warning, but is not insurance or a guaranty that such event will not occur or that there will be no personal injury or property loss as a result thereof. Consequently seller shall have no liability for any personal injury, property damage or loss based on a claim that the product fails to give warning. However, if seller is held liable, whether directly or indirectly, for any loss or damage arising under this limited warranty or otherwise, regardless of cause or origin, seller's maximum liability shall not exceed the purchase price of the product, which shall be complete and exclusive remedy against seller. No employee or representative of Seller is authorized to change this warranty in any way or grant any other warranty.

**WARNING:** This product should be tested at least once a week.

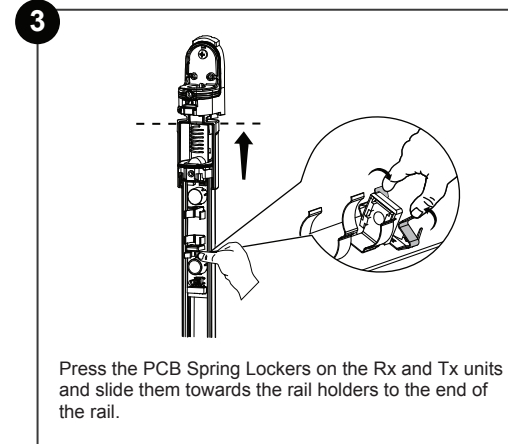

4

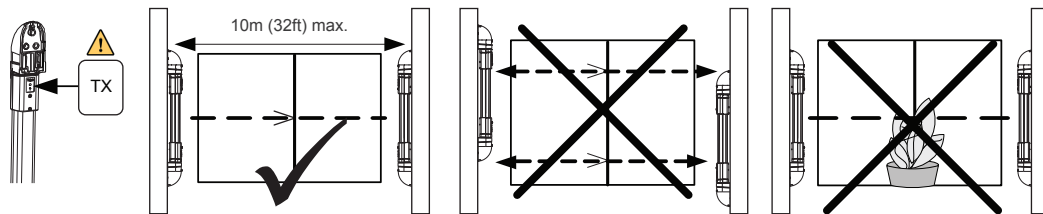

Select a mounting location. Make sure the TX / RX sticker is on the top of each rail.

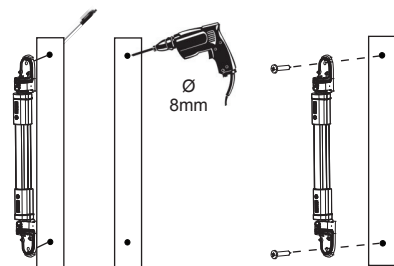

Mount the Tx and Rx rails to the wall.

5

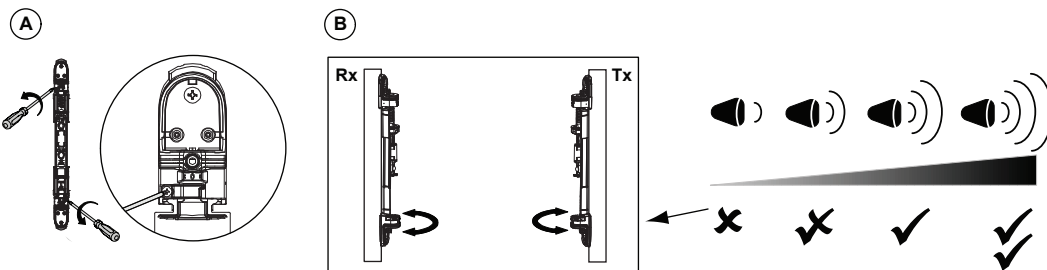

1. Insert the batteries first in the Tx unit then in The Rx unit.
2. Perform Rx-Tx beam alignment.
3. Listen to the buzzer for the maximum signal strength.

To improve signal strength:

A. Release the swivel locking screw on the top and bottom of both the Tx and Rx rails.

B. Swivel the Tx and Rx rails until maximum strength is received. Make sure you hear at least 3 beeps.

**Notes:** Installation mode will end after 4 minutes from power on or by pressing the Rx tamper switch.

To initiate the installation mode again: remove the battery for the Rx unit, wait and insert again.

**Note:** In the case of low battery, the red Alarm LED will flash 4 consecutive times.

6

Lock the swivel screws on both the Tx and Rx rails. Make sure that the alignment remains fixed.

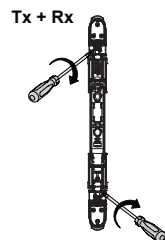

7

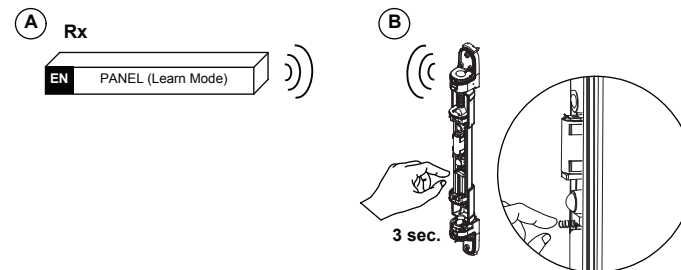

Set communication between the Rx and the security panel:

A. Set the panel to Learn mode.

B. Press the tamper spring for 5 seconds, verify that the detector has been identified by the panel.

8

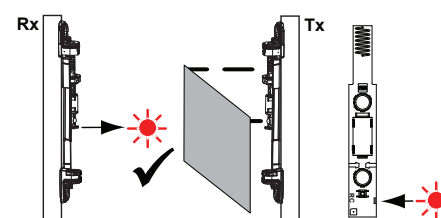

#### Walk Test

Block both IR lens make sure alarm led in Rx rail is ON.

9

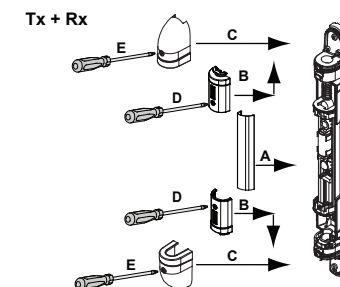

Close the Tx and Rx rails according to the A, B, C, D, E order in the diagram above.

#### Rx

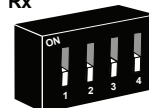

#### Rx control Dipswitch setting

No.	Function	Mode	
		OFF	ON
1.	RF transmission	High*	Low
2.	Interruption Time	600mSec*	300mSec
3.	Hold Status	2.5Min*	Immediate
4.	Spare	OFF*	

\* Default

i. For walk test purposes the hold-off time is automatically activated during the first 10 minutes after installation.

#### Technical Specifications

		Receiver	Transmitter
ELECTRICAL			
Batteries		CR123A, 3.0V Lithium Battery	
Battery Life		3 years typical, depends on usage	
Current Consumption @3.0V	Average	30µA	20µA
	Maximum	30mA	—
Supervision transmission		For 868.65 MHz model: every 15 minutes For 433.92 MHz model: every 65 minutes	
RADIO FREQUENCY			
RF Frequency		433.92/868.65MHz	—
Modulation Type		ASK	—
Address Codes		16 million	—
PHYSICAL			
Size (L x W x D)		370 x 14.5 x 42 mm (19.6 x 1.5 x 1.6 in.)	
Weight		0.3kg (0.66LB) without batteries	
OPTICAL			
Infrared Wave Length		—	940nm
Detection range (Max.)		10m (32ft).	
ENVIRONMENTAL			
Operation Temperature		-20°C to +60°C (4°F to 140°F)	
Storage Temperature		-25°C to +60°C (13°F to 140°F)	
RF Immunity		According to EN 50130-4	
IP Rating		IP65	