

# SMART4355HP

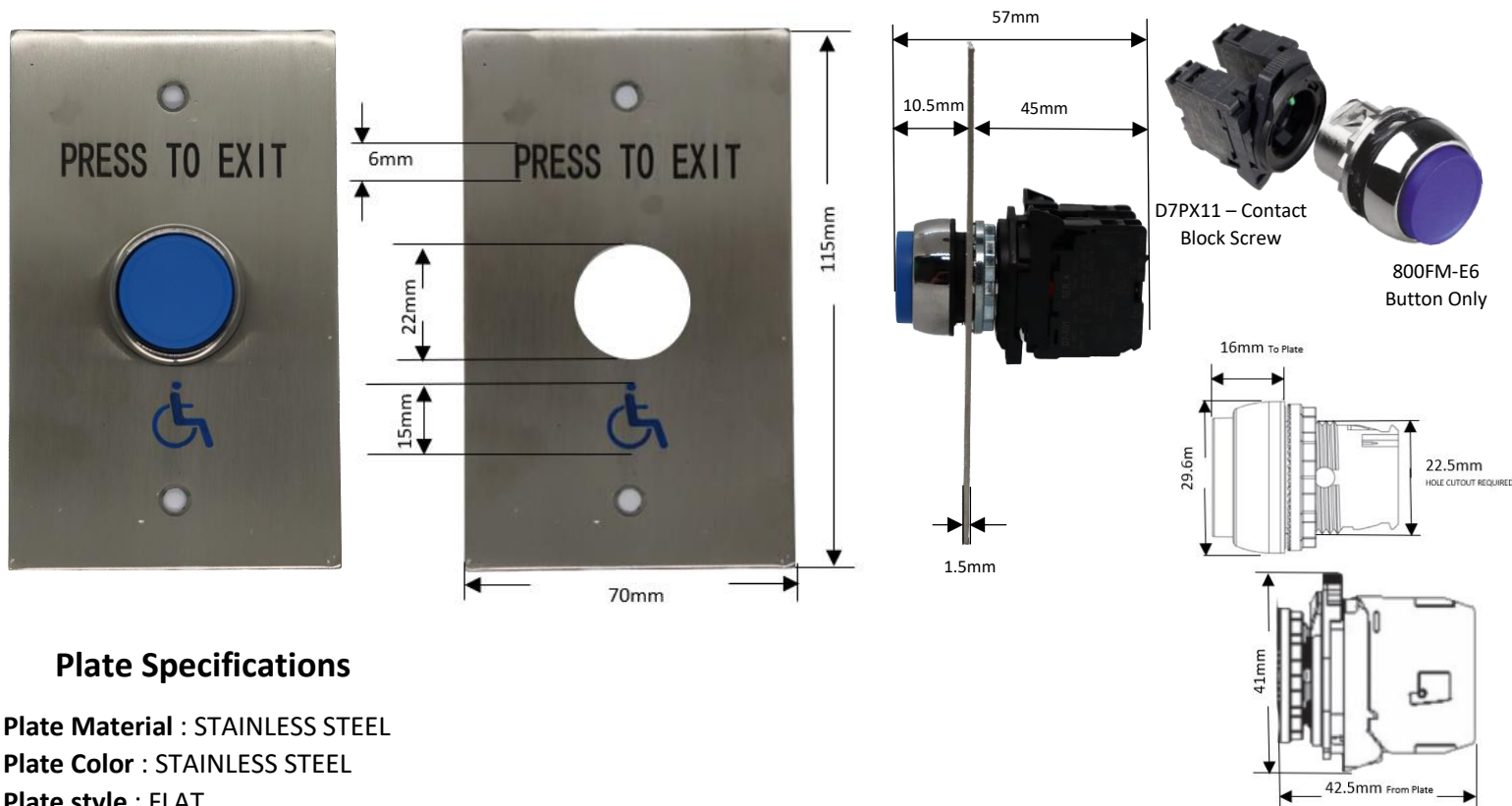

## Plate Specifications

**Plate Material :** STAINLESS STEEL  
**Plate Color :** STAINLESS STEEL  
**Plate style :** FLAT  
**Plate Text Printed :** "PRESS TO EXIT"  
**Plate Text Color :** BLACK  
**Plate Icon Printed :** WHEELCHAIR  
**Plate Icon Color :** BLUE  
**Plate Button Hole Cutout Size :** 22mm  
**Plate Mounting Holes :** 2  
**Plate Screw Hole Cutout Size :** 5mm  
**Plate Size :** 115Hx70Wx1.5D (mm)

## Switch Specifications

**Series :** 800FM  
**Material :** Plastic  
**Component Type :** Pushbutton  
**Component Style :** Extended Type  
**Button Color :** BLUE  
**Button Diameter:** 29.6 mm  
**Mounting Cutout Hole Size :** 22.5 mm  
**Material – Operator :** Zinc Alloy, Die Cast, Chrome Plated  
**Material – Bezel :** Zinc  
**Material – Body/Housing :** Body – Plastic, Housing – Zinc  
**Material – Spring :** Stainless Steel  
**Operator Action :** Momentary  
**Coupling Pate Included :** YES  
**Contact Block Included :** YES  
**IP Rating :** IP66  
**Illuminated :** NO  
**Tightening Torque Nominal :** 4.4 Nm

**Relative Humidity :** 50% ~ 95% RH  
**Mechanical Service Life :** 10000000 cycles  
**Shock Acceleration MAX :** 100 g  
**Shock Duration MAX :** 11 ms  
**Operating Temperature :** -25° ~ 70° C  
**Storage Temperature :** -40° ~ 85° C  
**Vibration Acceleration MAX :** 10 m/s<sup>2</sup>  
**Vibration Displacement (Peak to Peak MAX) :** 1.52 mm  
**Vibration Duration MAX :** 180 Mins  
**Vibration Frequency – Operational MAX :** 2000 Hz  
**Illuminated :** No  
**Button Size :** 29.6DIA x 35.6D (mm)  
**Certifications :** UR, UL, CSA, CCC, CE, RoHS  
**Standards Compliance :** NEMA ICS-5, UL 508, EN 60947-1, EN 60947-5-1, EN 60947-5-5, IEC 60947-1, ISO 13850  
**CE Marked :** Yes  
**RoHS Approved :** Yes