

ARLSWP-52

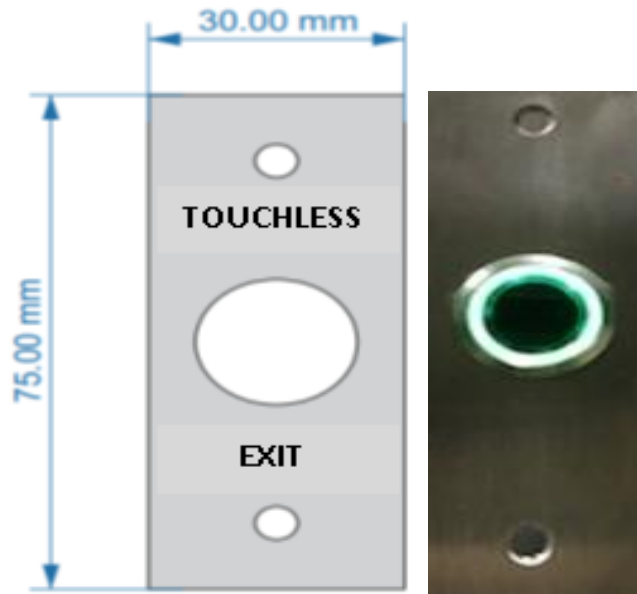

*Actual Product will carry Engraving as shown in the sketch

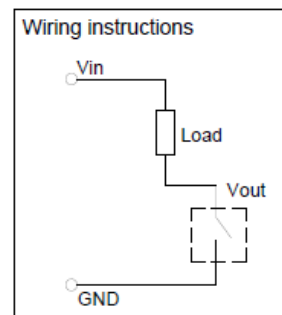
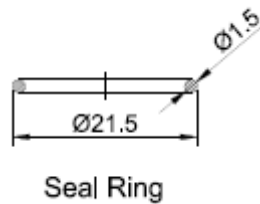
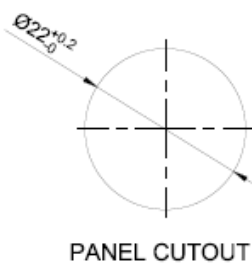
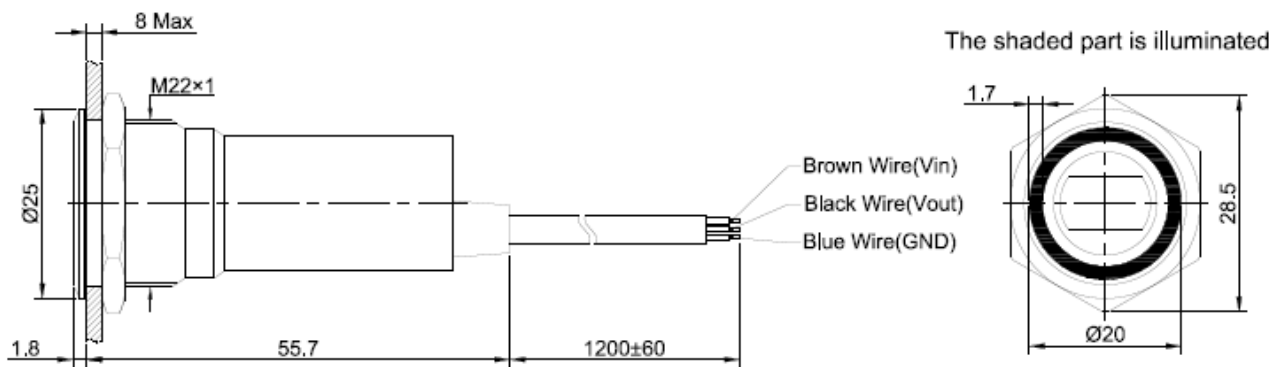

SPECIFICATIONS:

1. Switch Rating: DC6~24V/300mA.
2. Life: $\geq 1,000,000$ cycles.
3. Reaction Distance: 2~15cm.
4. Operation mode: NO Momentary.
5. Insulation Resistance: $\geq 1,000M\Omega$.
6. Dielectric Strength: 1,500V, RMS 50Hz, 1min.
7. Operating Temperature: $-15^{\circ}C \sim +55^{\circ}C$ (No Freezing).
10. Torque: About 0.6Nm max. applied to nut.
11. Protection degree: IP65.
12. Terminal Type: Sheltered cable.

MATERIALS:

1. Head: PMMA.
2. Body: Stainless Steel.