

SMART9448

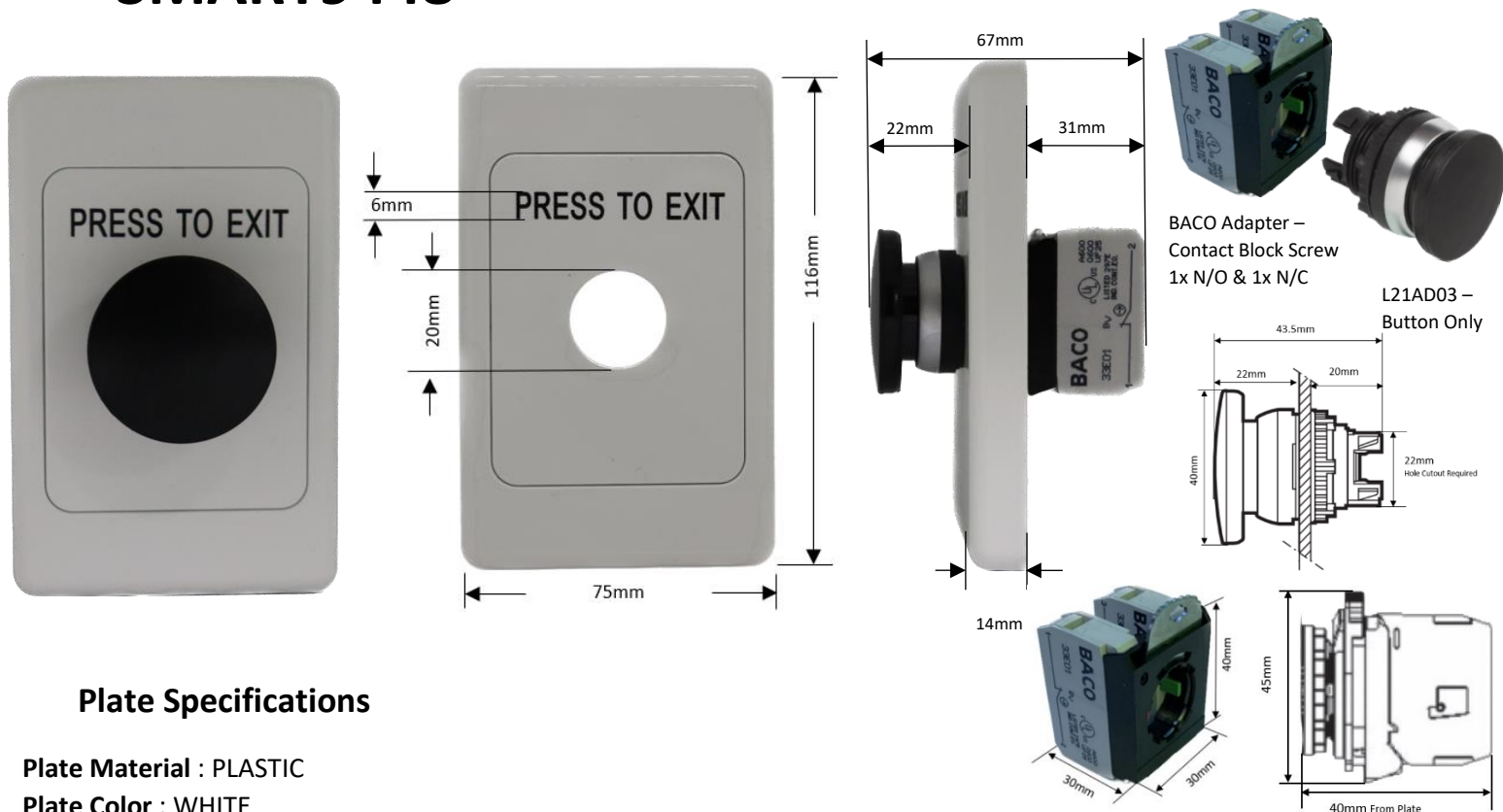

Plate Specifications

- Plate Material :** PLASTIC
- Plate Color :** WHITE
- Plate style :** STANDARD GPO
- Plate Text Printed :** "PRESS TO EXIT"
- Plate Text Color :** BLACK
- Plate Button Hole Cutout Size :** 22mm
- Plate Mounting Holes :** 2/4
- Plate Size :** 116Hx75Wx14D (mm)

Switch Specifications

- Series :** L21AD
- Material :** Plastic
- Component Type :** Pushbutton
- Component Style :** Mushroom Head Type
- Button Color :** BLACK
- Button Diameter:** 40 mm
- Mounting Cutout Hole Size :** 22 mm
- Material – Operator :** Plastic
- Material – Bezel :** Plastic
- Material – Body/Housing :** Plastic
- Material – Spring :** Stainless Steel
- Operator Action :** Momentary
- Coupling Pate Included :** YES
- Contact Block Included :** YES

- IP Rating :** IP65
- Illuminated :** NO
- Tightening Torque Nominal :** 3 Nm
- Relative Humidity :** 50% ~ 95% RH
- Operating Temperature :** -25° ~ 70° C
- Storage Temperature :** -40° ~ 70° C
- Vibration Acceleration MAX :** 10 m/s²
- Vibration Displacement (Peak to Peak MAX) :** 1.6 mm
- Vibration Frequency – Operational MAX :** 100 Hz
- Button Size :** 40DIA x 43.5D (mm)
- Certifications :** UL, OC/CB, BV IEC
- Standards Compliance :** UL 508, CSA 22.2, IEC 60947-5-1, IEC 60947-5-5, IEC 60947-5-4, IEC 60068-2-6