

ARLCPEXDFANS-RD

Key Reset Manual Call Point ATEX Approved Fire Alarm Explosion Proof Emergency Push Button IP66

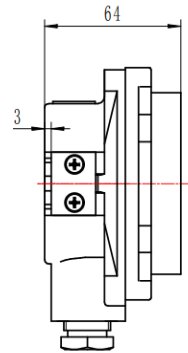

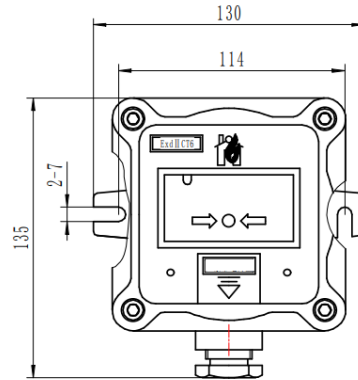



Overview

The **ARLCPEXDFANS-RD manual alarm button** is designed for use in hazardous environments. Certified to **GB3836 / GB12476**, it provides safe and reliable fire alarm activation in **Zone 1 & 2 (Gas IIA/IIB/IIC, T1–T6)** and **Zone 21 & 22 (Dust)**.

When pressed, it sends an alarm signal to the fire alarm controller. Equipped with LED indicators, key reset, and universal compatibility, it is a core element of explosion-proof fire alarm systems.

Key Features

-  **Key reset & self-locking** (compliant with latest standards)
-  **LED indicators:**
 - Green (standby) → always on
 - Red (alarm) → always on
-  **Compatible with all fire alarm controllers**
-  **IP45 / IP66 protection**
-  **Optional rain & mis operation covers**

Technical Specifications

Parameter	Value
Explosion-proof mark	Exd II CT6 Gb / ExtD A21 IP65 T85 °C
Working voltage	DC24V (non-polarized)
Output contact	DC30V / 100mA, passive NO
Indicators	Green (standby), Red (alarm)
Ingress protection	IP45 / IP65
Operating temp.	-20 °C ~ +50 °C
Humidity	≤95% RH (non-condensing)
Atmospheric pressure	80–110 kPa
Cable entry	G3/4 (IIB: sealing nut / IIC: sealed box)
Weight	1 kg

Installation

- **Wall-mounted** (M6 screws, ~1.5 m height)
 - **Column-mounted** (dedicated stand)
 - Connect wiring as follows:
 - **IN:** DC24V supply (non-polarized)
 - **OUT-1:** Passive NO contact
-

Safety Precautions

- ⚠ **Do not dismantle live equipment in hazardous areas**
- ⚠ Keep explosion-proof surfaces clean & intact; tighten screws evenly
- ⚠ Regular inspection required; repair/replacement only by qualified personnel