

# INDUSTRIAL SIGNALLING

## Bells

### MB series



- Solenoid bell available with 4, 6 and 8 inch gongs (4 inch 12 and 24V bells are motor driven)
- Available in red or grey
- IP55 in 6 and 8 inch sizes when back box is used, 4 inch bells for indoor use only.

Order Code	Voltage	Current	Sound Output dB@1m	Weight (kg)
<b>4 inch gong</b>				
MB101012D*	12VDC	40mA	83dB	0.4
MB101024D*	24VDC	20mA		
MB100240A*	240VAC	35mA		
<b>6 inch gong</b>				
MB150012D*	12VDC	110mA	85dB	1.0
MB150024D*	24VDC	60mA		
MB150240A*	240VAC	40mA		
<b>8 inch gong</b>				
MB200012D*	12VDC	110mA	88dB	1.76
MB200024D*	24VDC	60mA		
MB200240A*	240VAC	40mA		

**MBBOX\*** Back mounting box 110x110x140mm

\*Specify colour R = Red, G = Grey

#### Specifications:

Sound frequency: 2000-12,000Hz  
 Protection: IP20 or IP55 in 6 and 8" sizes when installed with back box  
 Temp rating (°C): -25 to +55  
 Duty cycle: 60min max.  
 Cable entry: Side and rear knockouts on back box  
 Construction: Steel gong, die cast aluminium housing and back box

Dimensions in mm

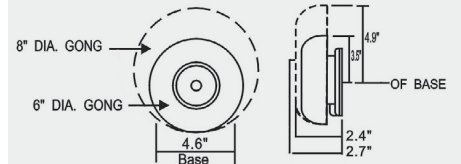
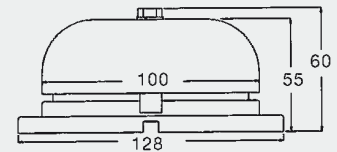

### CEAD



- Industrial solenoid bell
- Wide choice of voltages
- Available in red or grey
- Double insulated
- IP66

Order Code*	Voltage	Current
<b>CEAD – for AC voltage</b>		
SIR8040125*	12VAC	860mA
SIR8040245*	24VAC	430mA
SIR8040485*	48VAC	250mA
SIR8040605*	60VAC	170mA
SIR8041105*	110VAC	90mA
SIR8042405*	240VAC	50mA
<b>CEADEL – for DC voltage</b>		
SIR8040121*	12VDC	600mA
SIR8040241*	24VDC	300mA
SIR8040481*	48VDC	160mA
SIR8040601*	60VDC	120mA
SIR8041101*	110VDC	60mA
SIR8042401*	240VDC	28mA

\*Specify colour R = Red, G = Grey

#### Specifications:

Sound output: 98dB @ 1m DC versions  
 100dB @ 1m AC versions  
 Sound frequency: 2000-12000 Hz  
 Duty cycle: Continuous  
 Voltage tolerance: ±10%  
 Protection: IP66  
 Temp rating (°C): -30 to +50  
 Cable entry: M16  
 Construction: ABS and steel

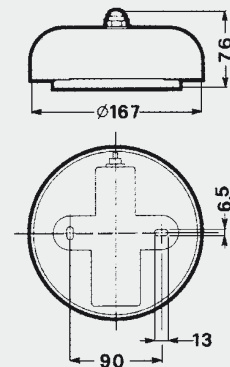

Dimensions in mm